

# Raccordi accessori Sprint® Serie S2000

Filetti dei raccordi: cilindrici (G1/8, G1/4, G3/8, G1/2),  
conici (R1/8, R1/4, R3/8, R1/2)



I raccordi accessori Serie S2000 sono caratterizzati da una grande affidabilità dei filetti femmina, sia cilindrici che conici, con superfici non piane. I modelli Sprint sono dotati di un particolare sistema di tenuta, già alloggiato sul filetto conico, che rende superfluo l'uso di collanti liquidi o del nastro PTFE ottimizzando la fase di montaggio.

Grazie a questo sistema di tenuta è possibile montare e smontare più volte il raccordo senza pregiudicare la tenuta sul filetto.

## CARATTERISTICHE GENERALI

<b>Materiale</b>	OT nichelato e PTFE
<b>Filettature</b>	GAS conico ISO 7 ( BSPT ) GAS cilindrico ISO 228 ( BSP )
<b>Pressione</b>	80 bar
<b>Fluido</b>	Aria compressa ed altri fluidi a bassa pressione.
<b>Temperatura</b>	-40°C + 120°C

## Raccordi Accessori Sprint®

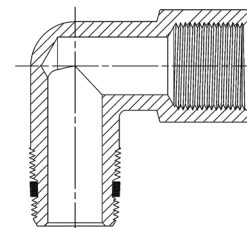

**Raccordi Mod. S2500**

Niplo Conico Sprint®

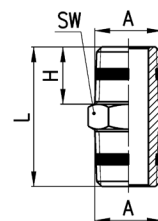
**DIMENSIONI**

Mod.	A	H	L	SW	Peso (g)
<b>S2500 1/8</b>	R1/8	7,5	19,5	12	8
<b>S2500 1/4</b>	R1/4	11	27	14	15
<b>S2500 3/8</b>	R3/8	11,5	28	17	21
<b>S2500 1/2</b>	R1/2	14	33,5	22	39

**Raccordi Mod. S2530**

Niplo Ridotto Conico Sprint®

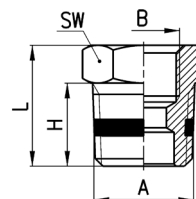
**DIMENSIONI**

Mod.	A	B	H	L	SW	Peso (g)
<b>S2530 1/4-1/8</b>	R1/4	G1/8	11	16	14	9
<b>S2530 3/8-1/8</b>	R3/8	G1/8	11,5	16,5	17	16
<b>S2530 1/2-1/8</b>	R1/2	G1/8	14	19,5	22	13
<b>S2530 3/8-1/4</b>	R3/8	G1/4	11,5	16,5	17	33
<b>S2530 1/2-1/4</b>	R1/2	G1/4	14	19,5	22	32
<b>S2530 1/2-3/8</b>	R1/2	G3/8	14	19,5	22	22

**Raccordi Mod. S2520**

Prolunga Riduzione Maschio Conica Sprint®

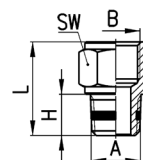
**DIMENSIONI**

Mod.	A	B	H	L	SW	Peso (g)
<b>S2520 1/8-1/8</b>	R1/8	G1/8	7,5	17,5	13	11
<b>S2520 1/8-1/4</b>	R1/8	G1/4	7,5	19	17	15
<b>S2520 1/8-3/8</b>	R1/8	G3/8	7,5	20	20	19
<b>S2520 1/4-1/4</b>	R1/4	G1/4	11	22,5	17	17
<b>S2520 1/4-3/8</b>	R1/4	G3/8	11	23,5	20	33
<b>S2520 1/4-1/2</b>	R1/4	G1/2	11	27,5	24	34
<b>S2520 3/8-3/8</b>	R3/8	G3/8	11,5	24	20	36
<b>S2520 3/8-1/2</b>	R3/8	G1/2	11,5	28	24	56
<b>S2520 1/2-1/2</b>	R1/2	G1/2	14	30,5	24	41

Raccordi Mod. S2510

Riduzione Conica Sprint®

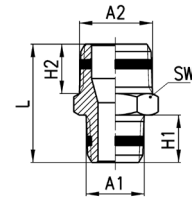

DIMENSIONI							
Mod.	A1	A2	H1	H2	L	SW	Peso (g)
<b>S2510 1/8-1/4</b>	R1/8	R1/4	7,5	11	23,5	14	14
<b>S2510 1/8-3/8</b>	R1/8	R3/8	7,5	11,5	24	17	22
<b>S2510 1/4-3/8</b>	R1/4	R3/8	11	11,5	27,5	17	19
<b>S2510 1/4-1/2</b>	R1/4	R1/2	11	14	30,5	22	33
<b>S2510 3/8-1/2</b>	R3/8	R1/2	11,5	14	31	22	36

Raccordi Mod. 2541

Nipplo Maschio Girevole Cilindrico Sprint®

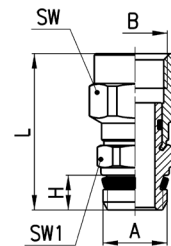

DIMENSIONI							
Mod.	A	B	H	L	SW	SW1	Peso (g)
<b>2541 1/8-1/8</b>	G1/8	G1/8	5,5	28	13	14	17
<b>2541 1/4-1/4</b>	G1/4	G1/4	7	31,5	17	14	26
<b>2541 3/8-3/8</b>	G3/8	G3/8	8	34	20	19	39

Raccordi Mod. S2010

Gomito Maschio Conico Sprint®

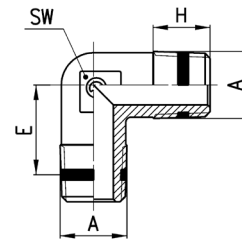

DIMENSIONI					
Mod.	A	E	H	SW	Peso (g)
<b>S2010 1/8</b>	R1/8	11,5	7,5	9	9
<b>S2010 1/4</b>	R1/4	13,5	11	12	17
<b>S2010 3/8</b>	R3/8	15,5	11,5	14	25
<b>S2010 1/2</b>	R1/2	16	14	16	47

Raccordi Mod. S2020

Gomito Femmina Maschio Sprint®

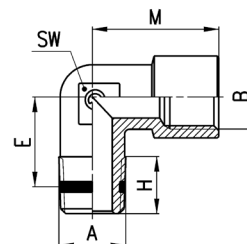

DIMENSIONI							
Mod.	A	B	E	H	M	SW	Peso (g)
<b>S2020 1/8-1/8</b>	R1/8	G1/8	11,5	8,5	19	11	16
<b>S2020 1/4-1/4</b>	R1/4	G1/4	15	11	23	13	27
<b>S2020 3/8-3/8</b>	R3/8	G3/8	15	11,5	25	15	33
<b>S2020 1/2-1/2</b>	R1/2	G1/2	17,5	14	31,5	20	62

**Raccordi Mod. S2050**

T.M.M.F. Sprint®

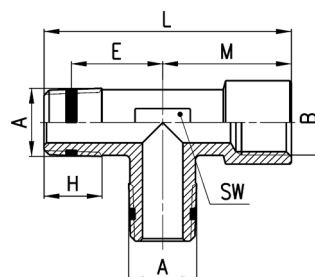
**DIMENSIONI**

Mod.	A	B	E	H	L	M	SW	Peso (g)
<b>S2050 1/8-1/8</b>	R1/8	G1/8	11,5	8,5	37	19	12	14
<b>S2050 1/4-1/4</b>	R1/4	G1/4	15	11	46	23	13	44
<b>S2050 3/8-3/8</b>	R3/8	G3/8	15	11,5	48,5	25	16	59
<b>S2050 1/2-1/2</b>	R1/2	G1/2	17,5	14	60,5	31,5	20	81

**Raccordi Mod. S2060**

T.F.M.F. Sprint®

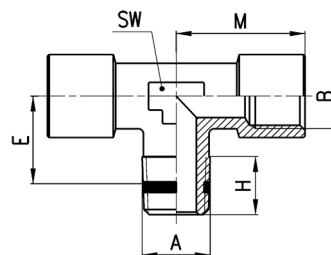
**DIMENSIONI**

Mod.	A	B	E	H	M	SW	Peso (g)
<b>S2060 1/8-1/8</b>	R1/8	G1/8	11,5	8,5	19	12	31
<b>S2060 1/4-1/4</b>	R1/4	G1/4	15	11	23	13	38
<b>S2060 3/8-3/8</b>	R3/8	G3/8	15	11,5	25	16	51
<b>S2060 1/2-1/2</b>	R1/2	G1/2	17,5	14	31,5	20	88

**Raccordi Mod. S2070**

T.M.F.F. Sprint®

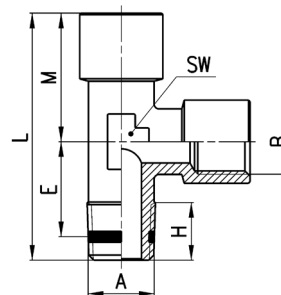
**DIMENSIONI**

Mod.	A	B	E	H	L	M	SW	Peso (g)
<b>S2070 1/8-1/8</b>	R1/8	G1/8	11,5	8,5	37	19	12	30
<b>S2070 1/4-1/4</b>	R1/4	G1/4	15	11	46	23	13	36
<b>S2070 3/8-3/8</b>	R3/8	G3/8	15	11,5	48,5	25	16	51
<b>S2070 1/2-1/2</b>	R1/2	G1/2	17,5	14	60,5	31,5	20	89

Raccordi Mod. S2080

T Maschio Sprint®

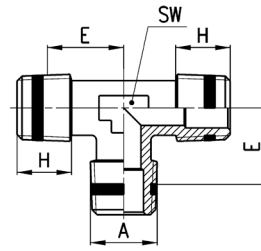

DIMENSIONI						
Mod.	A	E	H	SW	Peso (g)	
<b>S2080 1/8</b>	R1/8	11,5	7,5	9	14	
<b>S2080 1/4</b>	R1/4	13,5	11	12	31	
<b>S2080 3/8</b>	R3/8	15,5	11,5	14	50	
<b>S2080 1/2</b>	R1/2	16	14	16	63	

Raccordi Mod. S2090

T.M.F.M. Sprint®

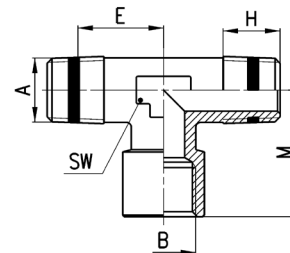

DIMENSIONI							
Mod.	A	B	E	H	M	SW	Peso (g)
<b>S2090 1/8-1/8</b>	R1/8	G1/8	11,5	8,5	19	12	22
<b>S2090 1/4-1/4</b>	R1/4	G1/4	15	11	23	13	16
<b>S2090 3/8-3/8</b>	R3/8	G3/8	15	11,5	25	16	59
<b>S2090 1/2-1/2</b>	R1/2	G1/2	17,5	14	31,5	20	80

Raccordi Mod. 2612 e Mod. S2610

Mod. 2612: Tappo Maschio Metrico  
Mod. S2610: Tappo Maschio Cilindrico Sprint®

Nuovo modello

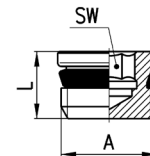

DIMENSIONI					
Mod.	A	L	SW	Peso (g)	
<b>2612 M5</b>	M5	5.5	2	1	con O-ring montato
<b>2612 M7</b>	M7	7	4	2	con O-ring montato
<b>S2610 1/8</b>	G1/8	7.5	4	3	
<b>S2610 1/4</b>	G1/4	9	6	6	
<b>S2610 3/8</b>	G3/8	10	8	12	
<b>S2610 1/2</b>	G1/2	11	10	21	

Raccordi Mod. S2615

Tappo Maschio a scomparsa  
Conico Sprint®

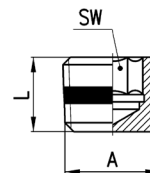

DIMENSIONI				
Mod.	A	L	SW	Peso (g)
<b>S2615 1/8</b>	R1/8	8	5	2
<b>S2615 1/4</b>	R1/4	10	7	6
<b>S2615 3/8</b>	R3/8	10	8	12