



BRACCIO DI REAZIONE

| TIPO | I | R | F | H | Ø E | A | B | Ø C | Ø d | Ø P | N° | Peso cad kit kg |
|------------|-----|----|------|----|-----|------|-------|-----|-----|-----|----|-----------------|
| CHT MV 25* | 70 | 15 | 17.5 | 14 | 8 | 33.5 | 118.5 | 55 | 7 | 45 | 4 | 0.17 |
| CHT MV 30* | 85 | 15 | 24 | 14 | 8 | 38 | 138 | 65 | 7 | 55 | 8 | 0.18 |
| CHT MV 40 | 100 | 18 | 31.5 | 14 | 10 | 44 | 162 | 75 | 7 | 60 | 8 | 0.24 |
| CHT MV 50 | 100 | 18 | 38.5 | 14 | 10 | 50 | 168 | 85 | 9 | 70 | 8 | 0.27 |
| CHT MV 63 | 150 | 18 | 49 | 14 | 10 | 55 | 223 | 95 | 9 | 80 | 8 | 0.57 |
| CHT MV 75 | 200 | 30 | 47.5 | 25 | 20 | 70 | 300 | 115 | 9 | 95 | 8 | 1.10 |
| CHT MV 90 | 200 | 30 | 57.5 | 25 | 20 | 80 | 310 | 130 | 11 | 110 | 8 | 1.26 |
| CHT MV 110 | 250 | 35 | 62 | 30 | 25 | 100 | 385 | 165 | 11 | 130 | 8 | 1.92 |
| CHT MV 130 | 250 | 35 | 69 | 30 | 25 | 125 | 410 | 215 | 14 | 180 | 8 | 2.23 |
| CHT MV 150 | 250 | 35 | 84 | 30 | 25 | 125 | 410 | 215 | 14 | 180 | 8 | 2.23 |

* Privo di boccola antivibrante

Il punto di ancoraggio del braccio di reazione è dotato di boccola antivibrante.

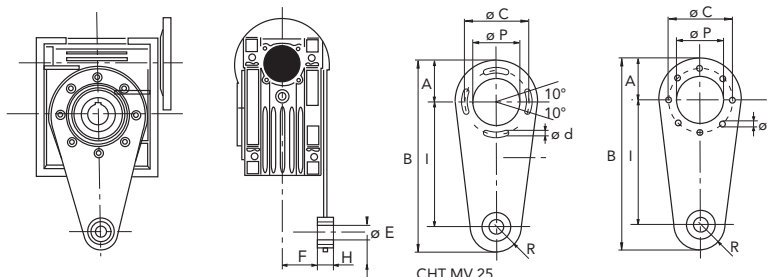

KIT ALBERO LENTO SEMPLICE

| TIPO | A | Ø d | B | b | t 1 | T | L | d 2 | Peso cad kit kg |
|-------------|----|-----|------|----|------|-------|-----|--------|-----------------|
| CHT MVS 25 | 23 | 11 | 25.5 | 4 | 12.5 | 55.5 | 81 | - | 0.07 |
| CHT MVS 30 | 30 | 14 | 32.5 | 5 | 16 | 69.5 | 102 | M6x16 | 0.14 |
| CHT MVS 40 | 40 | 18 | 43 | 6 | 20.5 | 85 | 128 | M6x16 | 0.27 |
| CHT MVS 50 | 50 | 25 | 53.5 | 8 | 28 | 99.5 | 153 | M10x22 | 0.60 |
| CHT MVS 63 | 50 | 25 | 53.5 | 8 | 28 | 119.5 | 173 | M10x22 | 0.67 |
| CHT MVS 75 | 60 | 28 | 63.5 | 8 | 31 | 128.5 | 192 | M10x22 | 0.94 |
| CHT MVS 90 | 80 | 35 | 84.5 | 10 | 38 | 149.5 | 234 | M12x28 | 1.79 |
| CHT MVS 110 | 80 | 42 | 84.5 | 12 | 45 | 164.5 | 249 | M16x35 | 2.70 |
| CHT MVS 130 | 80 | 45 | 85 | 14 | 48.5 | 180 | 265 | M16x35 | 3.60 |
| CHT MVS 150 | 82 | 50 | 87 | 14 | 53.5 | 210 | 297 | M16x35 | 5.00 |

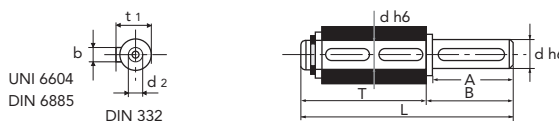

KIT ALBERO LENTO DOPPIO

| TIPO | A | Ø d | B | R | b | t 1 | L | d 2 | Peso cad kit kg |
|-------------|----|-----|------|-----|----|------|-----|--------|-----------------|
| CHT MVD 25 | 23 | 11 | 25.5 | 50 | 4 | 12.5 | 101 | - | 0.11 |
| CHT MVD 30 | 30 | 14 | 32.5 | 63 | 5 | 16 | 128 | M6x16 | 0.16 |
| CHT MVD 40 | 40 | 18 | 43 | 78 | 6 | 20.5 | 164 | M6x16 | 0.34 |
| CHT MVD 50 | 50 | 25 | 53.5 | 92 | 8 | 28 | 199 | M10x22 | 0.75 |
| CHT MVD 63 | 50 | 25 | 53.5 | 112 | 8 | 28 | 219 | M10x22 | 0.84 |
| CHT MVD 75 | 60 | 28 | 63.5 | 120 | 8 | 31 | 247 | M10x22 | 1.20 |
| CHT MVD 90 | 80 | 35 | 84.5 | 140 | 10 | 38 | 309 | M12x28 | 2.50 |
| CHT MVD 110 | 80 | 42 | 84.5 | 155 | 12 | 45 | 324 | M16x35 | 3.44 |
| CHT MVD 130 | 80 | 45 | 85 | 170 | 14 | 48.5 | 340 | M16x35 | 4.25 |

